



PUNCH UP TO 13/16" ROUND AND 9/16" SQUARE HOLES IN 1/2" THICK MILD STEEL ON THE SPOT!

Only The Cleveland Steel Tool Company has the quickest, easiest way to make round and shaped holes in mild steel up to 1/2" thick. Our 35-ton portable hydraulic punching unit is lightweight (weighs just 31 lbs.), easy to use and allows you to punch right on the job site. And, it punches in seconds.

The C-frame is forged, not cast, for greater durability and strength. The dual-action stripper holds the material being punched and then strips the material from the punch so you're ready to punch the next hole.

The Cleveland Steel Tool punching unit will operate from any 10,000 psi hydraulic source (an electric pump is available from The Cleveland Steel Tool Company). Each punching unit comes with four round punches and dies (your choice of round stock sizes) and its own carrying case.

All specifications are subject to change.
7.10.06

PORTA-PUNCH STANDARD FEATURES & SPECIFICATIONS

- Will operate from any 10,000 psi hydraulic source (electric hydraulic pump available from Cleveland Steel Tool).
- Comes in a metal carrying case.
- Can punch round, oblong, square, hex and rectangular holes.
- Shaped punches and dies available in 48 hours.
- Can be mounted to a workbench for production jobs.
- 3/8" female coupler attached.
- Three-year warranty against manufacturing defects.

THROAT OPENING:
2.75"
DIMENSIONS:
13-1/4" x 7-1/2" x 3-3/4"
WEIGHT:
31 Lbs.
PUNCHING CAPACITY:
13/16" round hole through
1/2" thick mild steel maximum

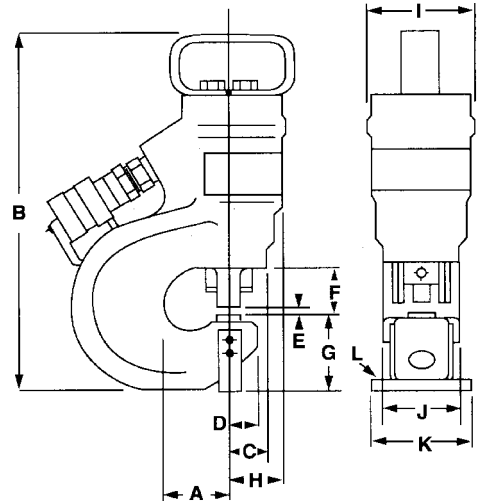

A MAX THROAT DEPTH	B	C	D	E	F	G	H	I	J	K	L MOUNT- ING HOLES
2 ³ / ₄	13 ³ / ₄	1 ¹ / ₂	1 ⁵ / ₁₆	9 ⁹ / ₁₆	2 ¹ / ₈	2 ⁷ / ₈	1 ¹³ / ₁₆	3 ³ / ₄	3 ¹ / ₁₆	3 ¹ / ₂	1 ¹ / ₄

ELECTRIC HYDRAULIC PUMP

STANDARD FEATURES & SPECIFICATIONS

- Available with hand held or foot remote control.
- Can be plugged into any 110 volt grounded outlet.
- Includes 10' wire wound high pressure hose with couplers.
- Attached 3/8" high pressure quick-disconnect coupler.
- 2-stage pump with automatic dump valve.
- Will start under full load.

MOTOR SIZE:
1/2 HP, 115 volt
Delivery @ 10,000 psi:
19 Cu. In./M
OIL CAPACITY:
1 gallon
WEIGHT:
29 Lbs.
DIMENSIONS:
8" x 10-1/2" x 16"



474 East 105th Street • Cleveland, Ohio 44108 USA
(216) 681-7400 • Fax (216) 681-7009
www.clevelandsteeltool.com

Call The Punchline
1-800-446-4402